

Summerproject 2020 in Germany

Wilhelmshaven, summer 2019

1987 - 2019

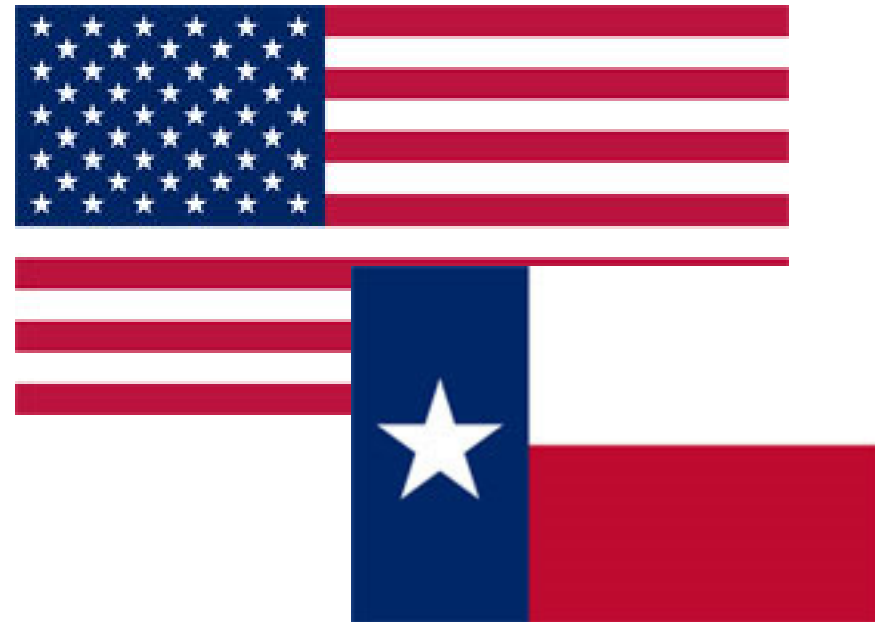

... very intensive with summerprograms and projects since 2012!



COME TO GERMANY

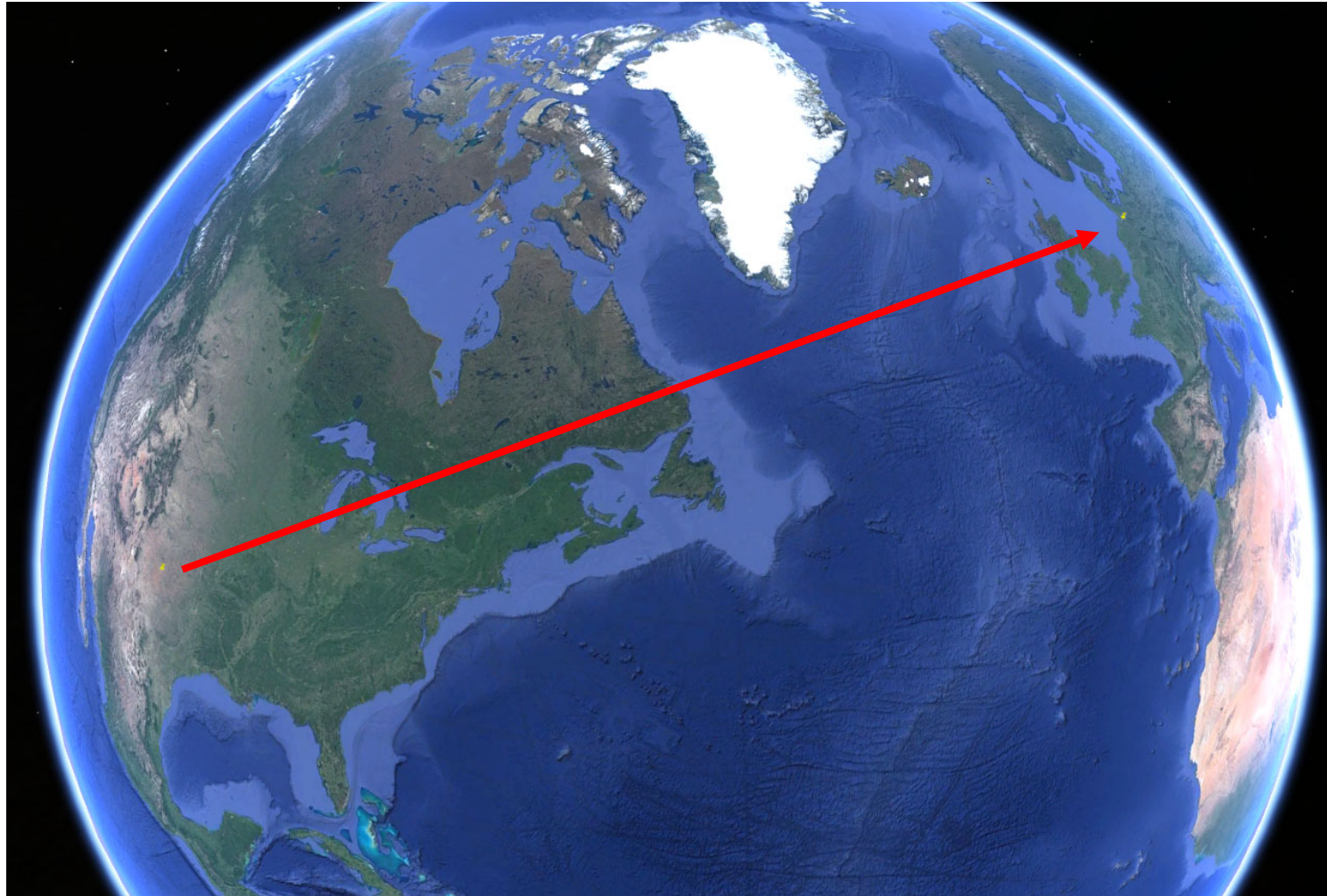

From USA - Texas- Lubbock to Europe - Germany - Wilhelmshaven

COME TO GERMANY

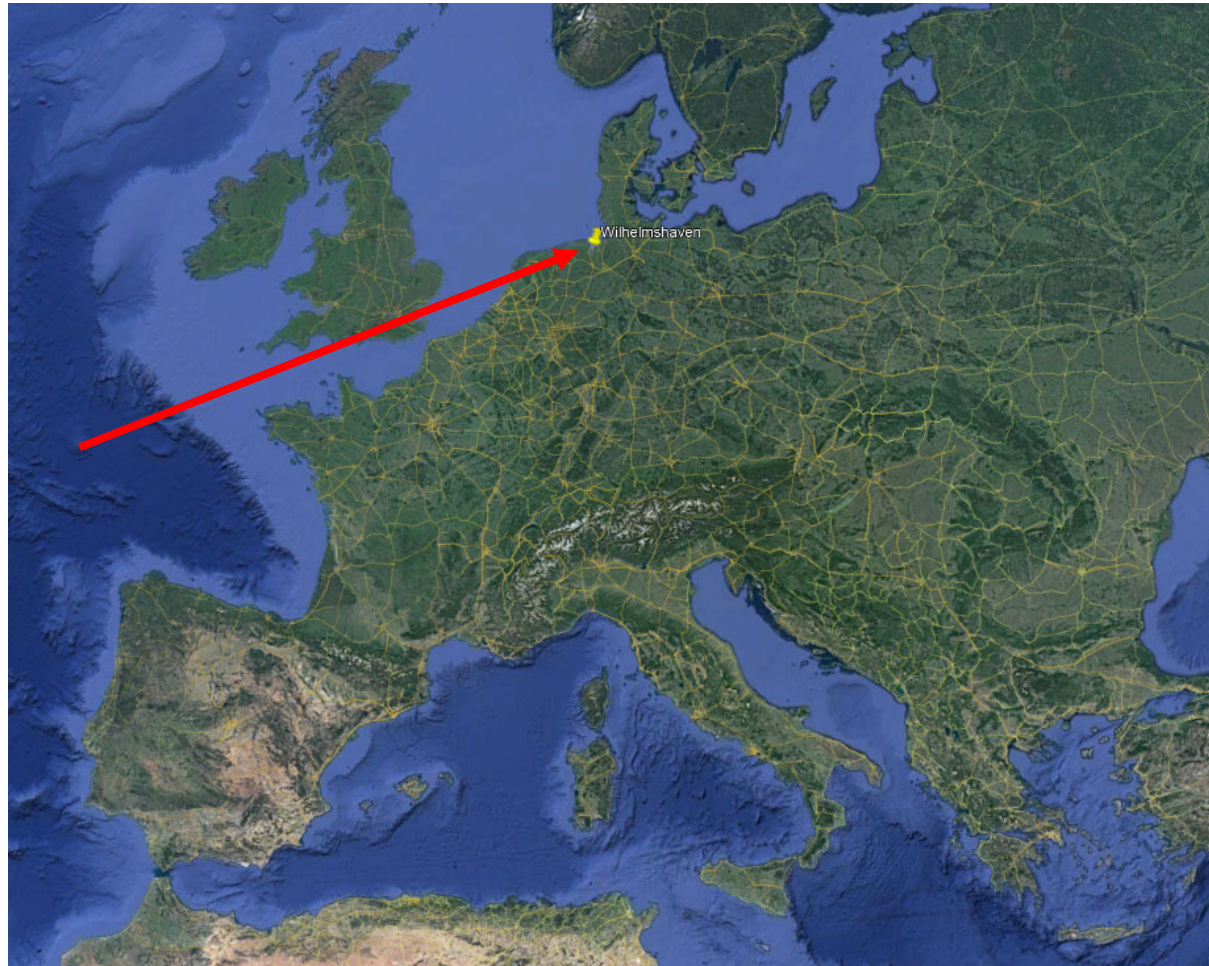

Europe - Germany - Wilhelmshaven

COME TO GERMANY



Germany - Wilhelmshaven

COME TO GERMANY



Wilhelmshaven

WILHELMSHAVEN



● Downtown – Hotel

● Campus



CAMPUS BIRDVIEW



CAMPUS MAINBUILDING



WILHELMSHAVEN

- City at the North Sea
Largest continuous tidal flats in the world!
Lower Saxony Wadden Sea National Park
UNESCO World Heritage since 2009



- Watersports



Watersports



4TH SUMMERPROJECT 2020 IN GERMANY



Cooperation since 1987 - Summerprojects since 2014

OFFER IN 2020: international smart home project

- March – September
- 6 weeks in Germany at Jade - July 6th to August 16th 2020
- 2 x 3 cts (3 cts theoretical part, 3 cts practical part)

March/April 2020 Distance work	<ul style="list-style-type: none"> • Grouping • Distribution of sub-projects • Literature research • Web conferences
Summer 2020 TTU students travel to Jade July 6 th to August 16 th	<ul style="list-style-type: none"> • First personal meetings • Preparatory classes • Detailed work packages • Creating functions • Resolving problems • Documentation
August/September 2020 Distance work	<ul style="list-style-type: none"> • Solving last problems • System tests • Documentation
September 2020 Jade students travel to TTU	<ul style="list-style-type: none"> • Finals tests • Final presentation at TTU

Costs

- \$2.500 housing & breakfast
- \$ 750 program & activities fee
- + TTU fees

www.jade-hs.de/ttu

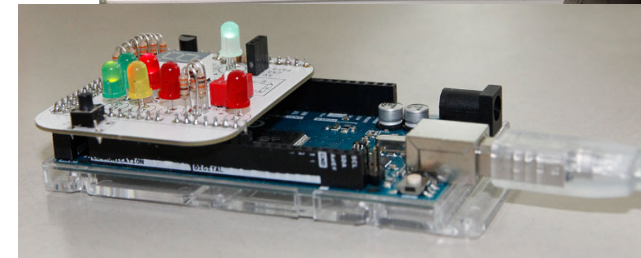

Largest continuous tidal flats in the world!
Lower Saxony
Wadden Sea
National Park
UNESCO World
Heritage since 2009



The project – overview:

International groups are built. 4-6 groups mixed with American and German students. **Each group will work on a sub-project!**

The students receive a complete physical system of a house model. By using their skills they have to...

- ... create a concept
- ... complete the phys. system with sensors and actors
- ... program the software and
- ... test the program
- ... control whole system via a wireless connection.
- ... **the results of the sub-projects will be finally presented at TTU.**

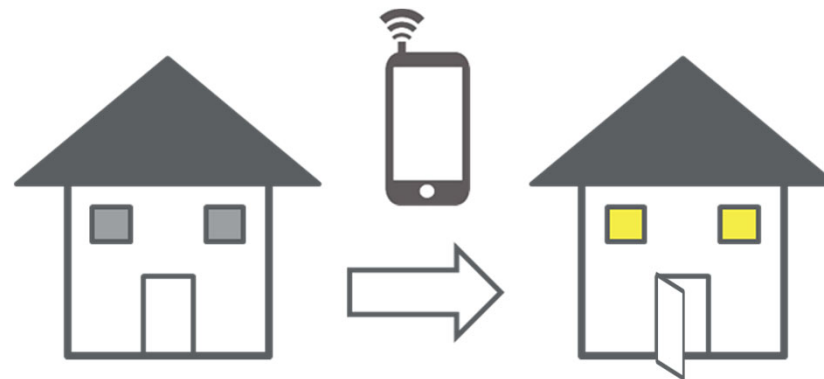

International groupwork.

Model home on a scale of 1:10



- Rooms have enough space for installing light and heating systems
- Roof with possibilities for the installation of a photovoltaic cells
- Foundation plate (place for control systems, electronics and storage)

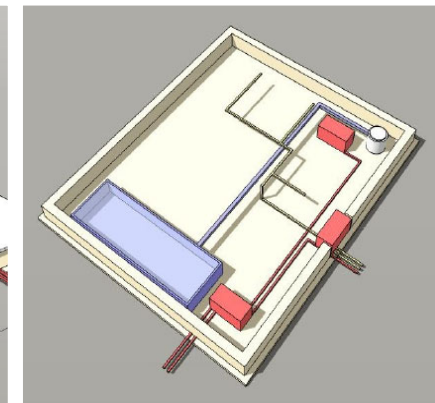
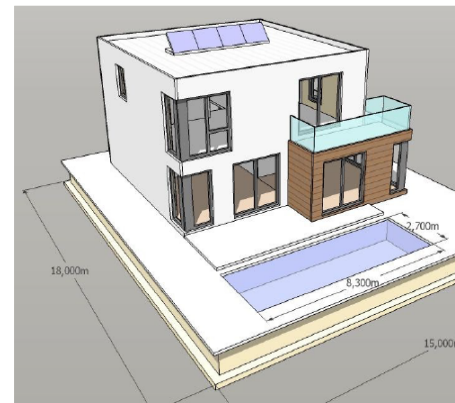

MODEL

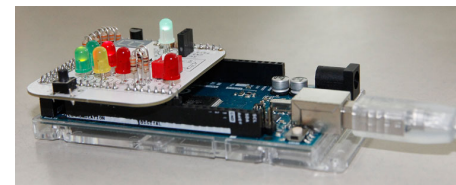
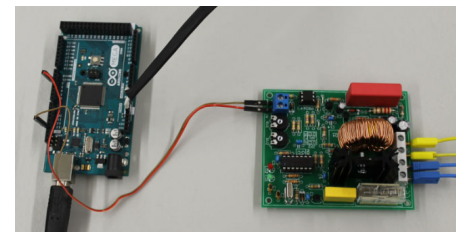
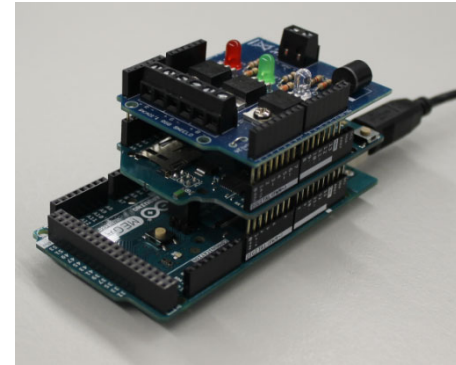
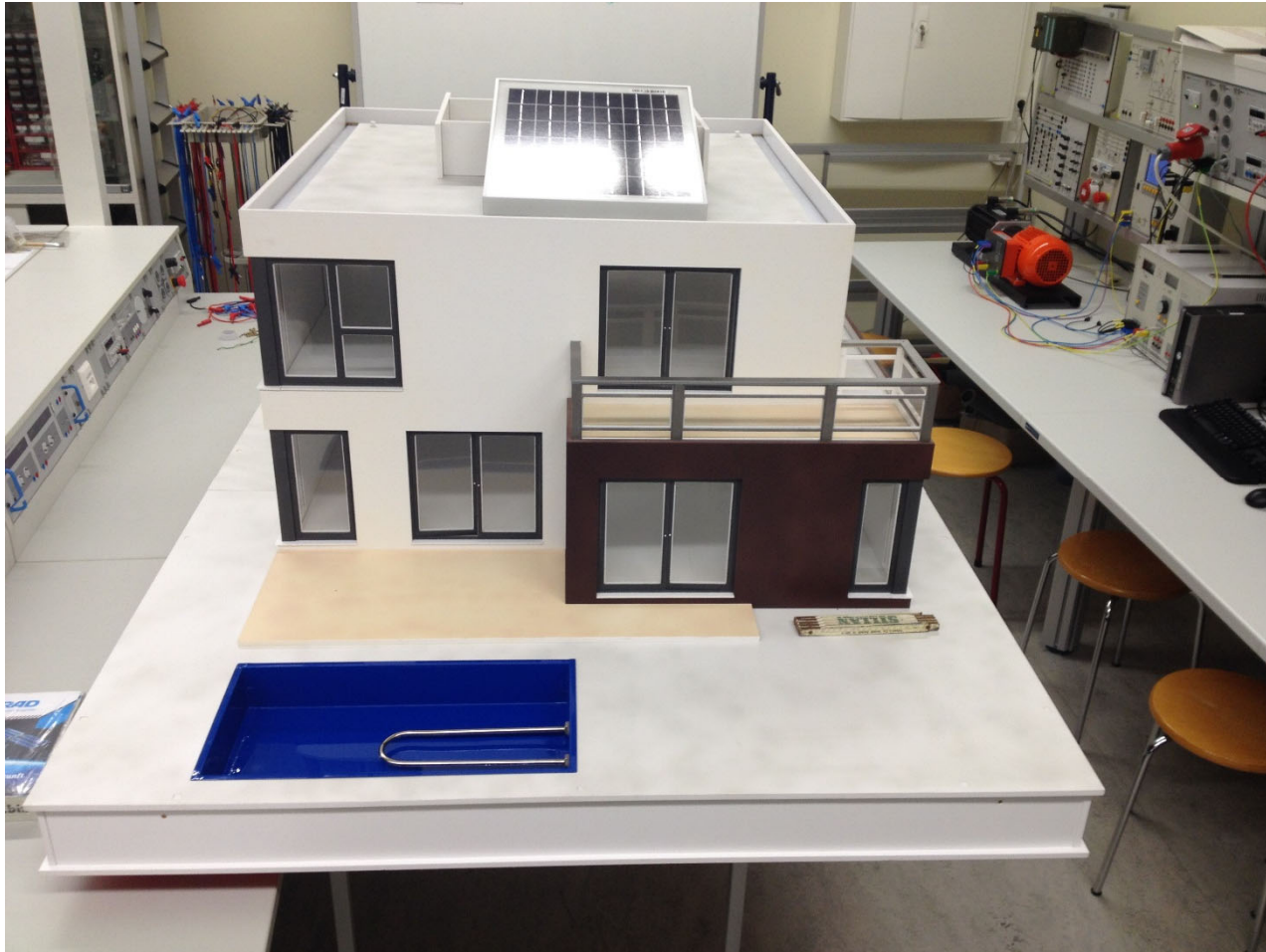

Model 1:10



FUNCTIONS

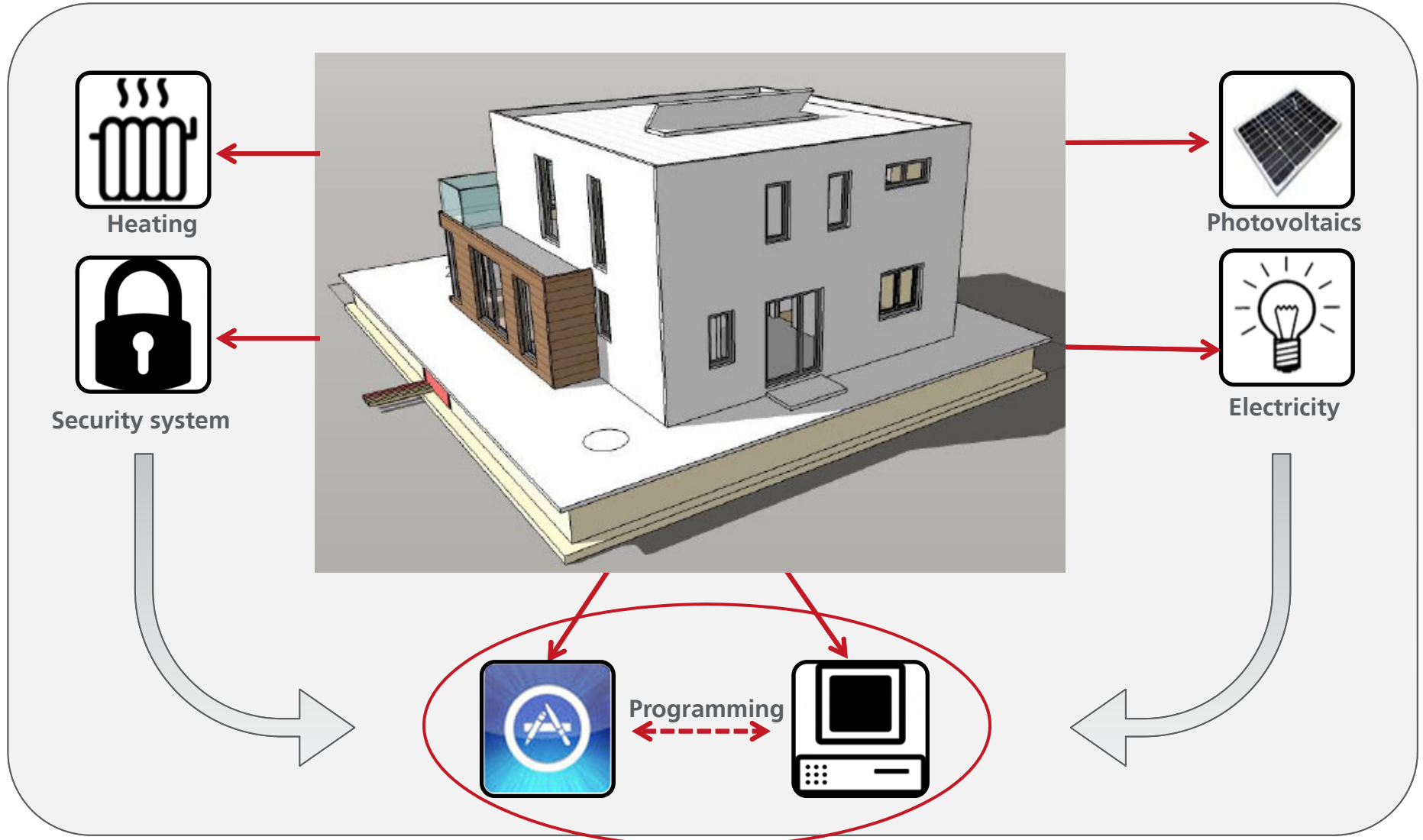

SUB-PROJECTS

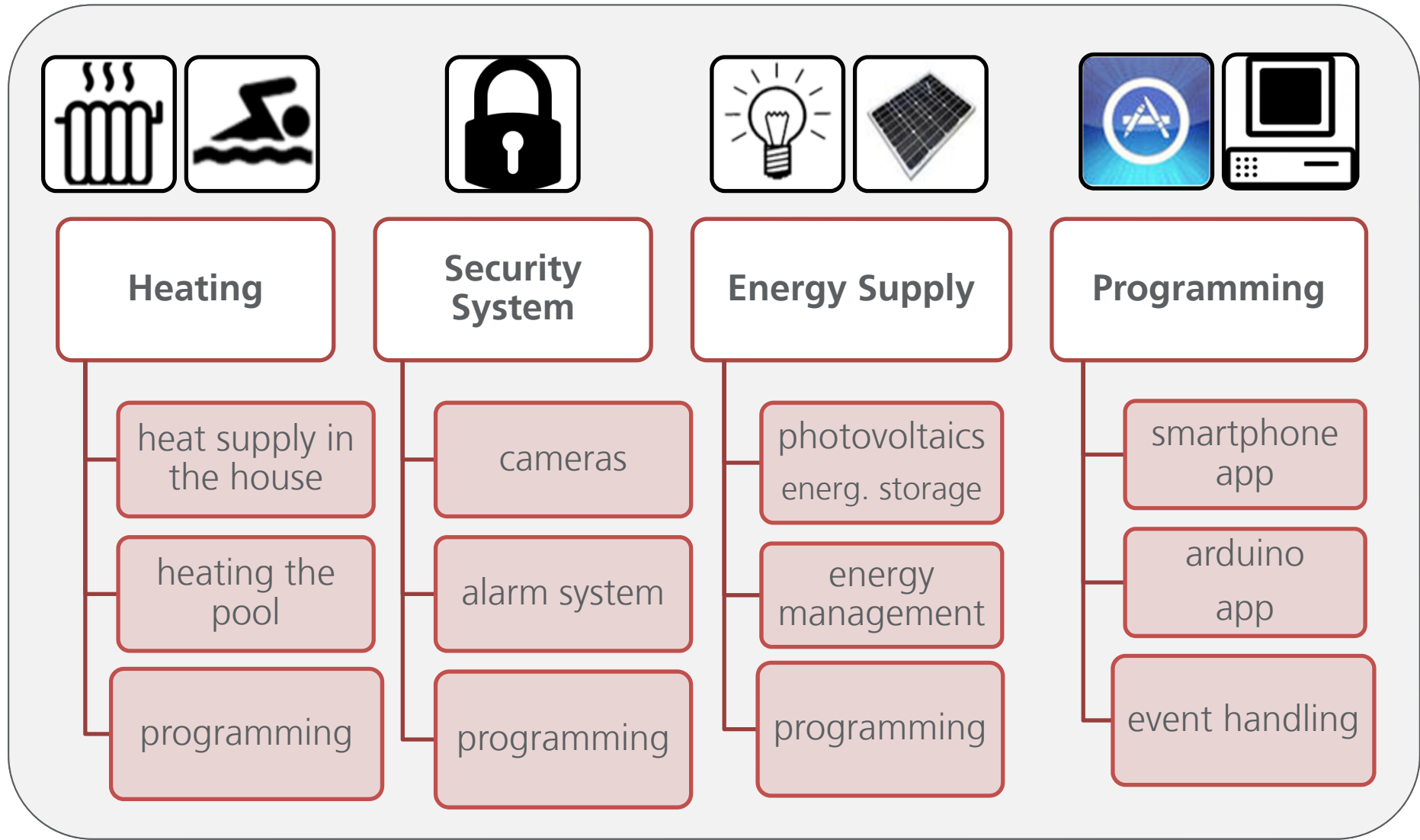

INTERNATIONAL EXPERIENCE



International experience during group-work in Wilhelmshaven



ADDITIONAL PROGRAM

Additional program

- welcome lunch
- guided town walk Wilhelmshaven
- sightseeing bus tour Wilhelmshaven
- welcome dinner
- visit of the German Emigration Center Bremerhaven
- volleyball with dinner
- Spiekeroog island daytrip - World Heritage Wadden Sea
- inner/outer harbor roundtrip
- visit of the German Navy museum
- final barbeque

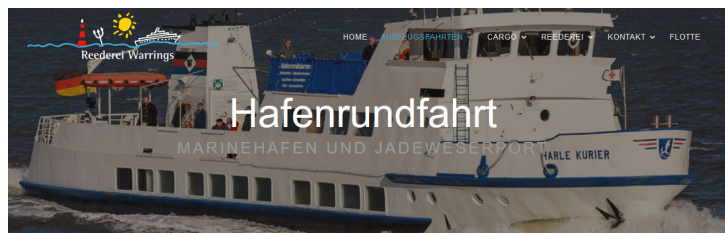

Having fun.



Visit Germany Wilhelmshaven!



ade Hochschule → The University → Departments → Engineering → International → Partner program Texas Tech

«International

- Partner program Texas Tech
 - Summer Program
 - Project

Partner program Texas Tech

The **Texas Tech University** in Lubbock, Texas, USA has been a partner university of the **Jade University of Applied Sciences** since 1987. The collaboration between the two universities is organized by the **Edward E. Whitacre Jr. College of Engineering** in Lubbock and the two departments **Engineering Sciences** and **Management, Information, Technology** in Wilhelmshaven.



Citation from the partnership agreement: "The purpose of the exchange program is to promote international friendship and world peace by stimulating and supporting intercultural activities and projects among students from Texas Tech and Jade Hochschule."

Summerprograms and summerprojects with German and American students have been held regularly since 2010. In addition to their intercultural competence, they acquire credits which can count towards their degree.

- yearly **summerprogram** July / August
- every two years **summerproject** April - September, next summerproject in 2020



Jade Hochschule
Department of Engineering Sciences
Dipl.-Ing. Volker Lübben
Friedrich-Paffrath-Straße 101

www.jade-hs.de/ttu

